

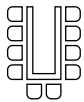

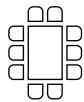
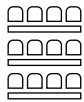
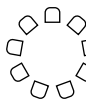

The room Gutshof-Saal is located on the first floor of the Gutshof and is 250 sqm big. The arrangement of the seating is flexible.

Category	Floor space	Ceiling height	Length/Width
XL	250 sqm	9.5 m	17m x 17m

Capacity

				
U-shape	Boardroom style	Classroom style	Round table	Theatre style
50	40	130	50	180

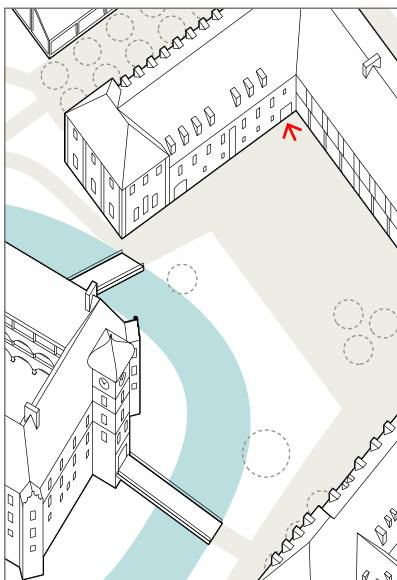

Equipment

Video/Audio

- High-performance projector HD 10.600 ANSI lumens (Panasonic PT DZ 110 XE) with VGA and HDMI port and screen
- High-end sound system
- Microphone system (wireless, clip-on / hand-held)
- Central room control with touch display
- Separate port for production desk or production room
- Catchbox
- Barco ClickShare with Airplay

Internet

- WLAN/LAN
- Exclusive, individually nameable WLAN with 25 Mbit/s bandwidth

And...

- Dial extension -934 for immediate support
- Room can be darkened electrically

Upon request at no extra cost

- Lectern, speaker podium
- Welcome desk with screen

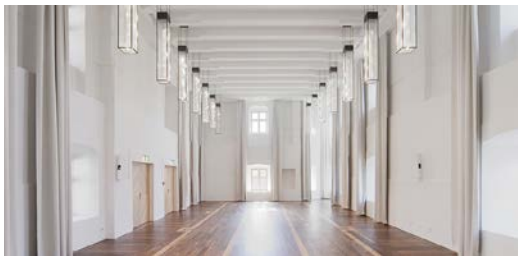
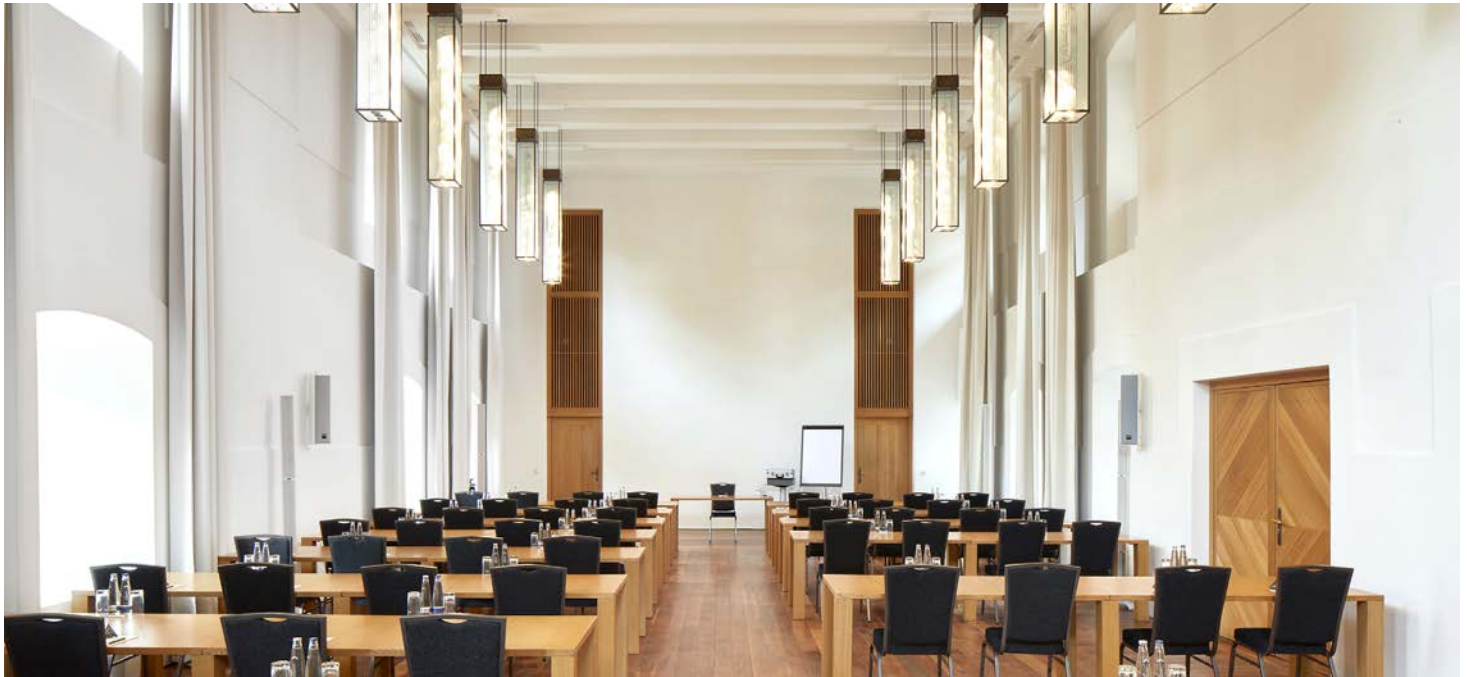

As well as notepad and pen at the desk for each participant



The room Schloßsaal is located on the first floor of the castle and is 165 sqm big. The arrangement of the seating is flexible.

Category	Floor space	Ceiling height	Length/Width
XL	165 sqm	6.4 m	19.6 m x 8.4 m

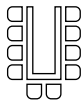
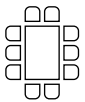
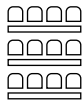
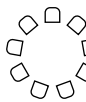
Capacity

				
U-shape	Boardroom style	Classroom style	Round table	Theatre style
44	–	80	50	120

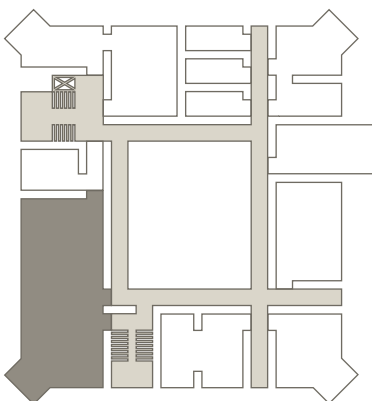

Equipment

Video/Audio

- High-performance projector HD 8.500 ANSI lumens (Christie DWU 951-Q) with VGA and HDMI port and projection wall
- High-end sound system
- Microphone system (wireless, clip-on/hand-held)
- Central room control with touch display
- Separate port for production desk or production room
- Catchbox
- Barco ClickShare with Airplay

Internet

- WLAN/LAN
- Exclusive, individually nameable WLAN with 25 Mbit/s bandwidth

And...

- Dial extension -934 for immediate support
- Room can be darkened electrically

Upon request at no extra cost

- Lectern, speaker podium
- Welcome desk with screen

As well as notepad and pen at the desk for each participant

Multimedia



2021 08 06



The room Multimedia is located on the ground floor of the Gutshof and is 120 sqm big. The arrangement of the seating is flexible. The room is equipped with a terrace.

Category	Floor space	Ceiling high	Length/Width
L	120 sqm	3.2m	21.3m x 10.4m

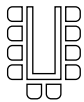
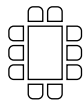
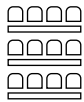
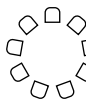
Capacity

				
U-shape	Boardroom style	Classroom style	Round table	Theatre style
40	40	40	30	70

Equipment

- Video/Audio**
- weframe One 86" (219 cm diagonal, multitouch 4K display) with HDMI port and Airplay
 - Barco ClickShare with Airplay
 - High-performance projector 4K Ultra HD 2.900 ANSI lumens with VGA and HDMI port and screen

- Internet**
- WLAN/LAN

- Facilitation**
- 1 large presentation kit
 - 2 quality flipcharts with wheels
 - 3 quality pinboards with wheels
 - 1 quality BlackPad

- And...**
- Dial extension -934 for immediate support
 - Activity Box

As well as notepad and pen at the desk for each participant

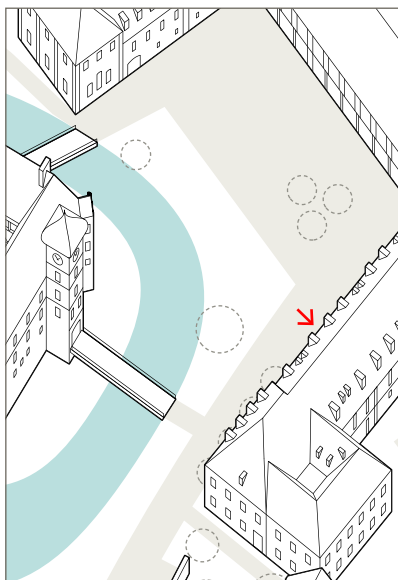



The room Giebinger Forst is located on the third floor of the castle and is 120 sqm big. It features an atmosphere out of the ordinary. The arrangement of the seating is open.

Category	Floor space	Ceiling height	Length/Width
L	120 sqm	2.6 m	20.0 m x 6.0 m

Capacity

Open seating arrangement
 Standard seating possible
 Seats 25

Equipment

Video/Audio

- weframe One 86" (219 cm diagonal, multitouch 4K display) with HDMI port
- Barco Click Share

Internet

- WLAN/LAN

Facilitation

- 1 large presentation kit
- 2 quality flipcharts with wheels
- 1 quality flipchart firmly attached
- 2 wooden pinboards firmly attached
- 2 wooden pinboards sideways moveable
- 2 quality pinboards with wheels

And...

- Dial extension -934 for immediate support

As well as notepad and pen at the desk for each participant

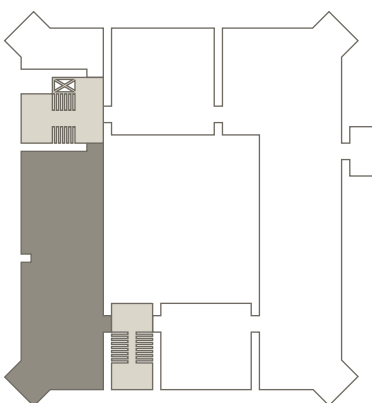





The room Kammerberg is located on the second floor of the castle and is 109 sqm big. It features an oriel, about 2.5 m x 2.5 m big. The arrangement of the seating is flexible.

Category	Floor space	Ceiling height	Length/Width
L	109 sqm	2.8 m	14.5 m x 7.5 m

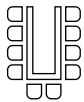
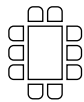
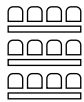
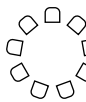
Capacity

				
U-shape	Boardroom style	Classroom style	Round table	Theatre style
30	32	50	30	60

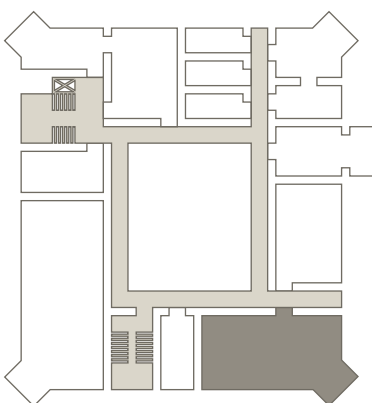

Equipment

Video/Audio

- weframe One 86" (219 cm diagonal, multitouch 4K display) with HDMI port and Airplay
- Barco ClickShare with Airplay

Internet

- WLAN/LAN

Facilitation

- 1 large presentation kit
- 2 quality flipcharts with wheels
- 3 quality pinboards with wheels
- 1 quality BlackPad

And...

- Dial extension -934 for immediate support
- Activity Box



As well as notepad and pen at the desk for each participant



The room Benonia is located on the second floor of the Gutshof and is 90 sqm big. The arrangement of the seating is flexible.

Category	Floor space	Ceiling high	Length/Width
L	90 sqm	2.4 m	19.2 m x 7.5 m

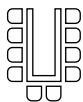
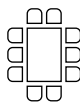
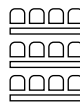
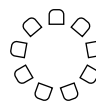
Capacity

				
U-shape	Boardroom style	Classroom style	Round table	Theatre style
30	34	36	30	50

Equipment

Video/Audio

- weframe One 86" (219 cm diagonal, multitouch 4K display) with HDMI port and Airplay
- Barco ClickShare with Airplay
- High-performance projector 4K Ultra HD 2.900 ANSI lumens with VGA and HDMI port and screen

Internet

- WLAN/LAN

Facilitation

- 1 large presentation kit
- 2 quality flipcharts with wheels
- 3 quality pinboards with wheels
- 1 quality BlackPad

And...

- Dial extension -934 for immediate support
- Activity Box

As well as notepad and pen at the desk for each participant

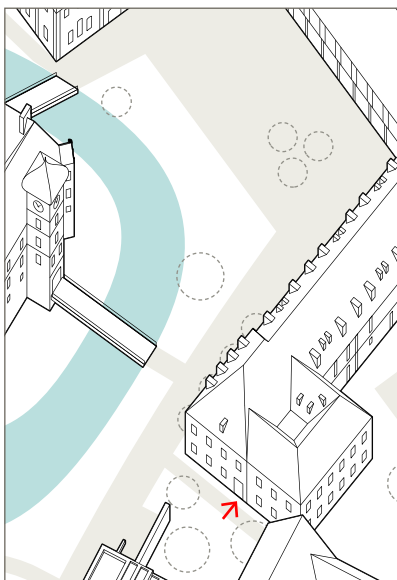





The room Reichertshausen is located on the second floor of the castle and is 78sqm big. The arrangement of the seating is flexible.

Category	Floor space	Ceiling height	Length/Width
L	78sqm	2.8m	9.6m x 8.1m

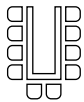
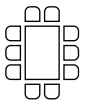
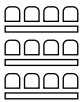
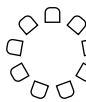
Capacity

				
U-shape	Boardroom style	Classroom style	Round table	Theatre style
18	20	24	22	50

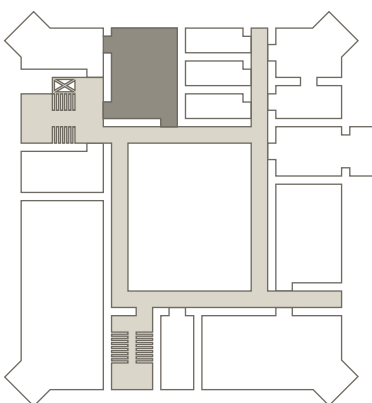

Equipment

- Video/Audio**
- weframe One 86" (219 cm diagonal, multitouch 4K display) with HDMI port and Airplay
 - Barco ClickShare with Airplay

- Internet**
- WLAN/LAN

- Facilitation**
- 1 large presentation kit
 - 2 quality flipcharts with wheels
 - 3 quality pinboards with wheels
 - 1 quality BlackPad

- And...**
- Dial extension -934 for immediate support
 - Activity Box

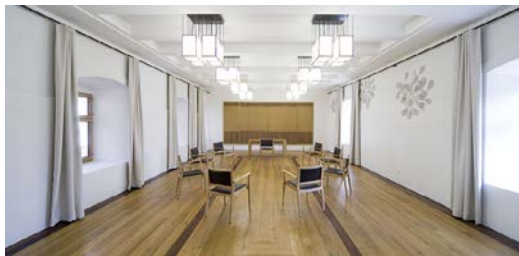

As well as notepad and pen at the desk for each participant



The room Thalhausen is located on the first floor of the castle and is 74 sqm big. The arrangement of the seating is flexible.

Category	Floor space	Ceiling height	Length/Width
L	74 sqm	3.2m	11.5m x 6.4m

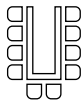
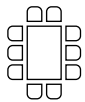
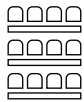
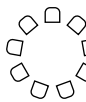
Capacity

				
U-shape	Boardroom style	Classroom style	Round table	Theatre style
24	28	34	22	50

Equipment

Video/Audio

- weframe One 86" (219 cm diagonal, multitouch 4K display) with HDMI port and Airplay
- Barco ClickShare with Airplay

Internet

- WLAN/LAN

Facilitation

- 1 large presentation kit
- 2 quality flipcharts with wheels
- 3 quality pinboards with wheels
- 1 quality BlackPad

And...

- Dial extension -934 for immediate support
- Activity Box

As well as notepad and pen at the desk for each participant

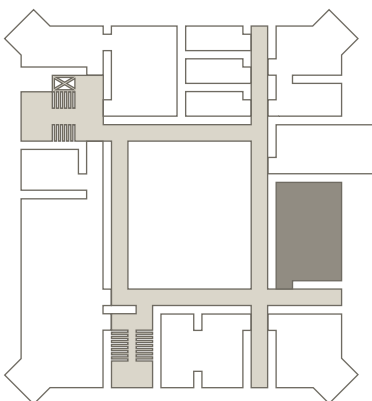





The room Weihenstephan is located on the second floor of the castle and is 74 sqm big. The arrangement of the seating is flexible.

Category	Floor space	Ceiling high	Length/Width
L	74 sqm	2.8 m	11.1 m x 6.7 m

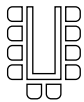
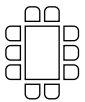
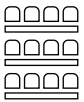
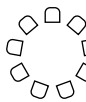
Capacity

				
U-shape	Boardroom style	Classroom style	Round table	Theatre style
24	28	34	22	50

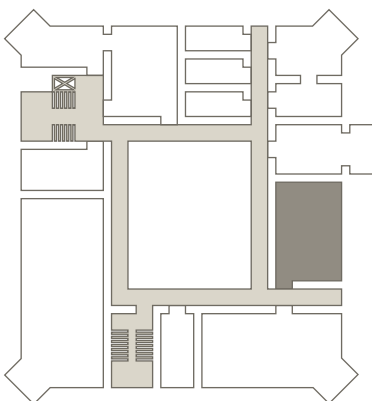

Equipment

Video/Audio

- weframe One 86" (219 cm diagonal, multitouch 4K display) with HDMI port and Airplay
- Barco ClickShare with Airplay

Internet

- WLAN/LAN

Facilitation

- 1 large presentation kit
- 2 quality flipcharts with wheels
- 3 quality pinboards with wheels
- 1 quality BlackPad

And...

- Dial extension -934 for immediate support
- Activity Box

As well as notepad and pen at the desk for each participant



The room Werkstatt für Neues is located in the rear building of the Baronessvilla and is 75 sqm big. It features three outdoor working areas and an atmosphere out of the ordinary. The arrangement of the seating is open.

Category	Floor space	Ceiling height	Length/Width
M	75 sqm	3.0m	8.7m x 8.6m

Capacity

Open seating arrangement
 Seats 12

Equipment

- Video/Audio**
- High-performance projector 4K Ultra HD 2.900 ANSI lumens with VGA and HDMI port and screen

Internet

- WLAN

Facilitation

- Innovative presentation material
- Extraordinary working material
- 3 Metaplan boards

And...

- Dial extension -934 for immediate support

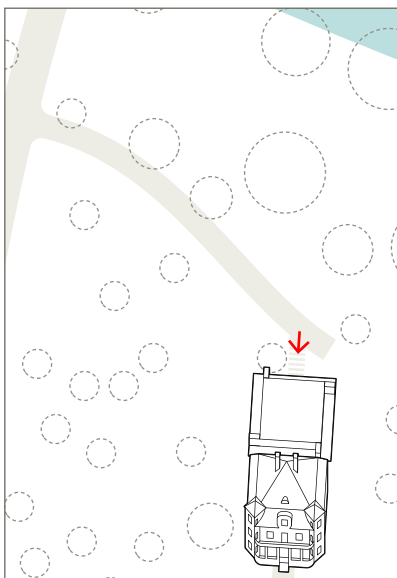



The room Stuckzimmer is located on the first floor of the castle and is 71 sqm big, split into 43 and 28 sqm. The seating arrangement is permanent.

Category	Floor space	Ceiling height	Length/Width
M	43sqm+28sqm	3.2m	7.4m×5.7/3.7m

Capacity

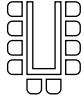
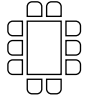
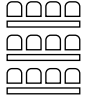
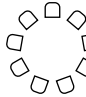
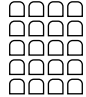
				
U-shape	Boardroom style	Classroom style	Round table	Theatre style
-	14	-	-	-

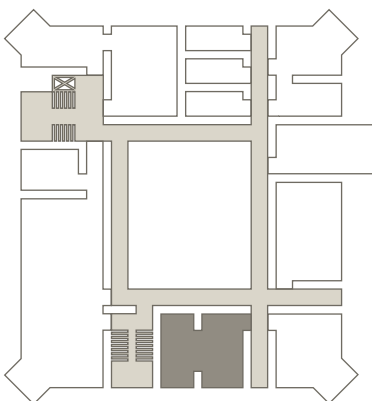

Equipment

- Video/Audio**
- weframe One 86" (219 cm diagonal, multitouch 4K display) with HDMI port
 - Barco ClickShare

- Internet**
- WLAN/LAN

- Facilitation**
- 1 large presentation kit
 - 1 quality flipchart with wheels
 - 2 quality pinboards with wheels

- And...**
- Dial extension -934 for immediate support



As well as notepad and pen at the desk for each participant



The room Kaminzimmer is located on the ground floor of the Gutshof and is 68 sqm big. The arrangement of the seating is flexible. The room is equipped with a terrace (garden furniture is provided during the summertime).

Category	Floor space	Ceiling high	Length/Width
M	68 sqm	3.4 m	13.4 m x 5.1 m

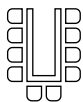
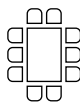
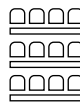
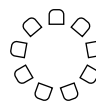
Capacity

				
U-shape	Boardroom style	Classroom style	Round table	Theatre style
18	18	20	14	32

Equipment

- Video/Audio**
- weframe One 86" (219 cm diagonal, multitouch 4K display) with HDMI port
 - Barco ClickShare

- Internet**
- WLAN/LAN

- Facilitation**
- 1 large presentation kit
 - 1 quality flipchart with wheels
 - 2 quality pinboards with wheels

- And...**
- Dial extension -934 for immediate support

As well as notepad and pen at the desk for each participant

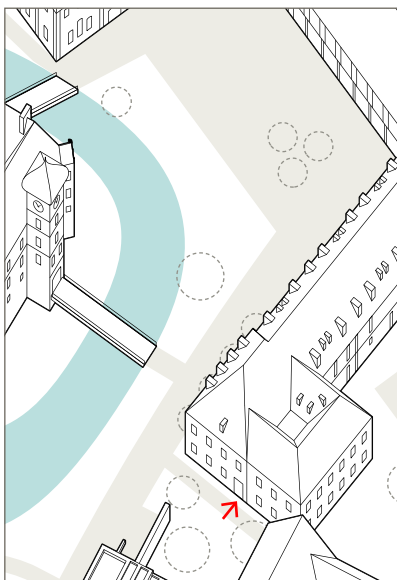



The room Kleines Gewölbe is located on the first floor of the castle and is 65 sqm big. It features an atmosphere out of the ordinary. The arrangement of the seating is open.

Category	Floor space	Ceiling high	Length/Width
M	65 sqm	2.8 m	9.8 m x 8.4 m

Capacity

Open seating arrangement
 Seats 12

Recommended for

Fireside evening for informal exchange and open mingling as well as coaching, job interviews, target talks, etc.

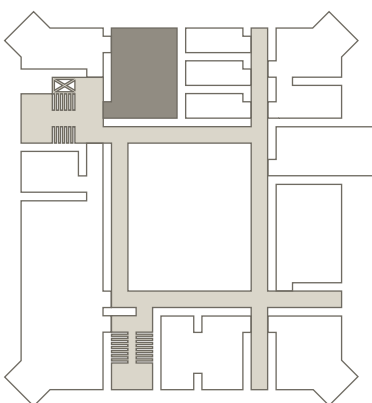

Equipment

Internet

– WLAN/LAN

And...

– Dial extension -934 for immediate support

As well as notepad and pen at the desk for each participant

Scagliolazimmer



2021 08 06



The room Scagliolazimmer is located on the first floor of the castle and is 48sqm big. It features an oriel, about 2.5 m x 2.5 m big. The arrangement of the seating is flexible.

Category	Floor space	Ceiling high	Length/Width
M	48sqm	3.2m	7.4m x 6.5m

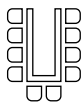
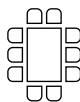
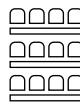
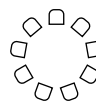
Capacity

				
U-shape	Boardroom style	Classroom style	Round table	Theatre style
14	15	18	18	30

Equipment

- Video/Audio**
- weframe One 86" (219 cm diagonal, multitouch 4K display) with HDMI port
 - Barco Click Share

- Internet**
- WLAN/LAN

- Facilitation**
- 1 large presentation kit
 - 1 quality flipchart with wheels
 - 2 quality pinboards with wheels

- And...**
- Dial extension -934 for immediate support

As well as notepad and pen at the desk for each participant

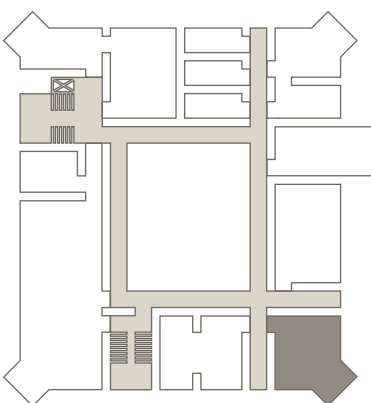



The room Glonnblick is located on the ground floor of the Altes Försterhaus and is 48 sqm big. It features an atmosphere out of the ordinary. The arrangement of the seating is open.

Category	Floor space	Ceiling high	Length/Width
M	48 sqm	2.9m	7.2m x 6.6m

Capacity

Open seating arrangement
 Seats 12

Equipment

- Video/Audio**
- Flat screen, 65" television
 - Barco ClickShare

- Internet**
- WLAN

Facilitation

- 1 large presentation kit
- 1 quality flipchart with wheels
- 2 quality pinboards with wheels
- 1 quality black pad firmly attached

– **And...**

Dial extension -934 for immediate support

As well as notepad and pen at the desk for each participant

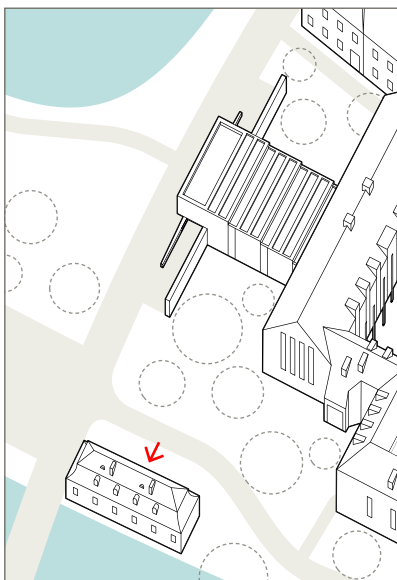





The room Klausur 2 is located on the ground floor of the castle and is 42 sqm big. It features an oriel, about 2.5 m x 2.5 m big. The arrangement of the seating is flexible.

Category	Floor space	Ceiling high	Length/Width
M	42 sqm	2.6 m	6.9 m x 6.1 m

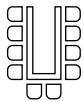
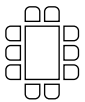
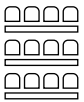
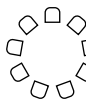
Capacity

				
U-shape	Boardroom style	Classroom style	Round table	Theatre style
10	12	11	14	16

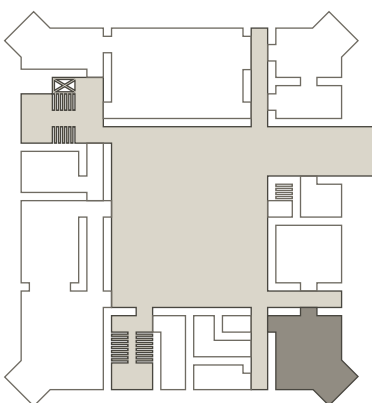

Equipment

- Video/Audio**
- weframe One 86" (219 cm diagonal, multitouch 4K display) with HDMI port
 - Barco ClickShare

- Internet**
- WLAN/LAN

- Facilitation**
- 1 large presentation kit
 - 1 quality flipchart with wheels
 - 2 quality pinboards with wheels

- And...**
- Dial extension -934 for immediate support



As well as notepad and pen at the desk for each participant



The room Klausur 1 is located on the ground floor of the castle and is 42 sqm big. The arrangement of the seating is flexible.

Category	Floor space	Ceiling high	Length/Width
M	42 sqm	2.6 m	7.0 m x 6.2 m

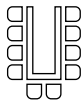
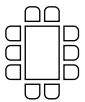
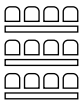
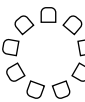
Capacity

				
U-shape	Boardroom style	Classroom style	Round table	Theatre style
10	12	11	14	16

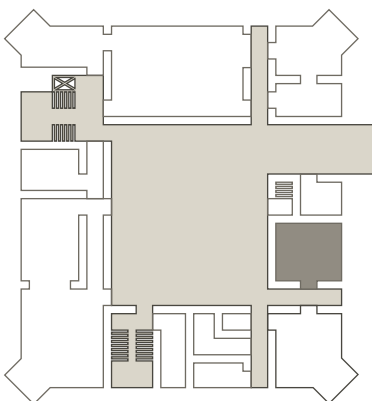

Equipment

Video/Audio

- weframe One 86" (219 cm diagonal, multitouch 4K display) with HDMI port
- Barco ClickShare

Internet

- WLAN/LAN

Facilitation

- 1 large presentation kit
- 1 quality flipchart with wheels
- 2 quality pinboards with wheels

And...

- Dial extension -934 for immediate support

As well as notepad and pen at the desk for each participant

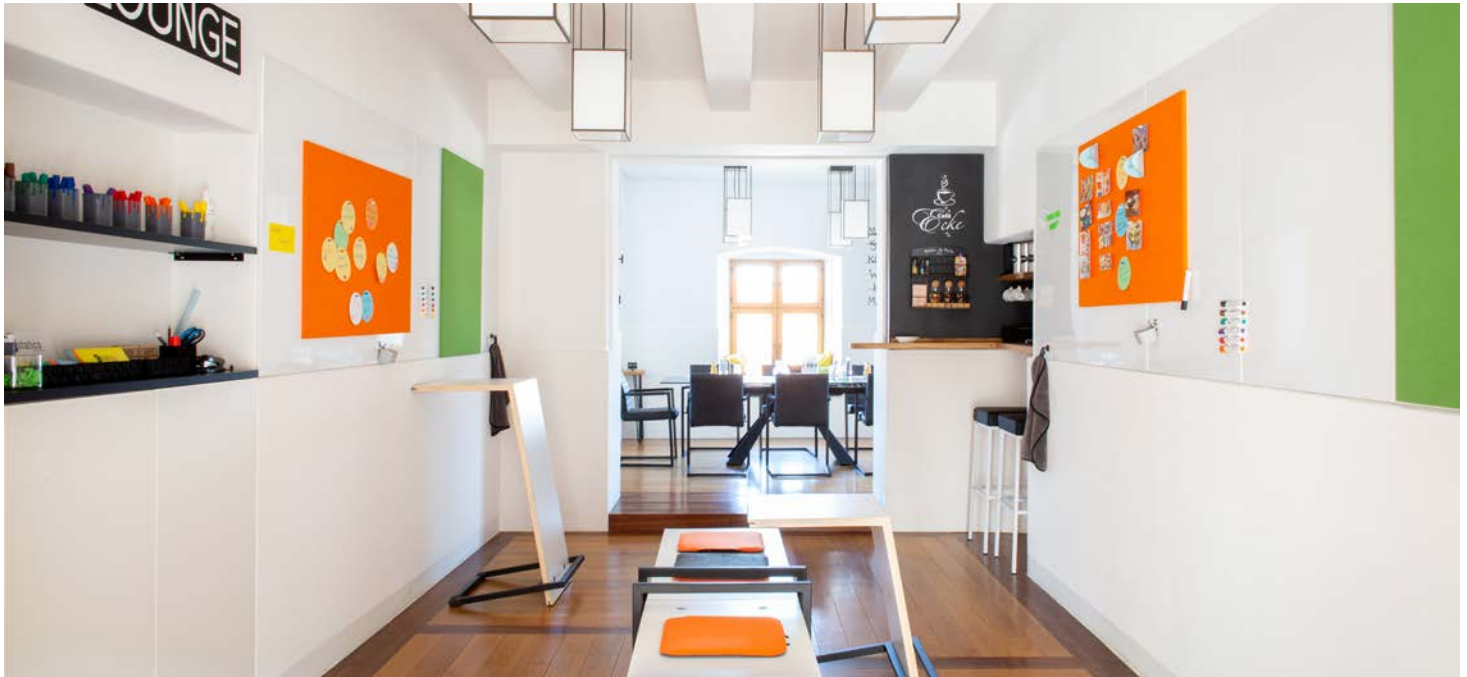

The room Turmzimmer is located on the second floor of the castle and is 42 sqm big, which includes a 16 sqm big oriel. It features two working areas and an atmosphere out of the ordinary.

Category	Floor space	Ceiling height	Length/Width
M	42 sqm	2.8 m	6.7/4.6m x 3.5m

Capacity

Two working areas with permanent and open seating arrangement
 Seats 8

Equipment

Internet

- WLAN/LAN

Facilitation

- High-quality working materials
- Writable magnetic walls
- Coloured repositionable magnetic pin boards

And...

- Dial extension -934 for immediate support

As well as notepad and pen at the desk for each participant

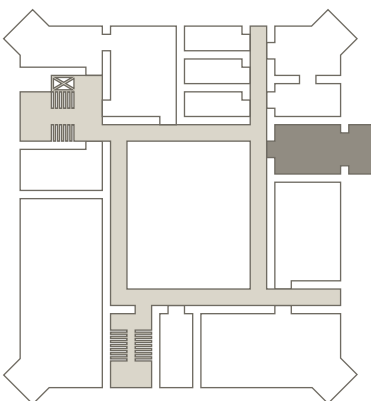





The room Wappenzimmer is located on the second floor of the castle and is 41 sqm big. It features an oriel, about 2.5 m x 2.5 m big. The seating arrangement is permanent.

Category	Floor space	Ceiling high	Length/Width
M	41 sqm	2.8 m	8.3 m x 4.8 m

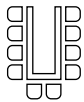
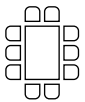
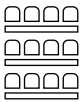
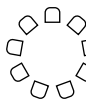
Capacity

				
U-shape	Boardroom style	Classroom style	Round table	Theatre style
-	14	-	-	-

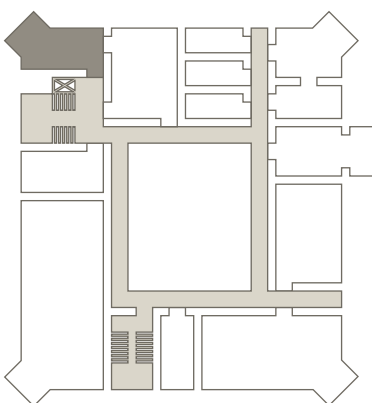

Equipment

- Video/Audio**
- weframe One 86" (219 cm diagonal, multitouch 4K display) with HDMI port
 - Barco ClickShare

- Internet**
- WLAN/LAN

- Facilitation**
- 1 large presentation kit
 - 1 quality flipchart with wheels
 - 2 quality pinboards with wheels

- And...**
- Dial extension -934 for immediate support

As well as notepad and pen at the desk for each participant



The room Klausur 3 is located on the first floor of the castle and is 38 sqm big. It features an oriel, about 2.5 m x 2.5 m big. The seating arrangement is permanent.

Category	Floor space	Ceiling high	Length/Width
M	38 sqm	3.2m	8.2 m x 4.6 m

Capacity

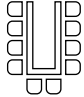
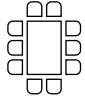
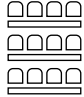
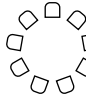
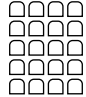
				
U-shape	Boardroom style	Classroom style	Round table	Theatre style
-	14	-	-	-

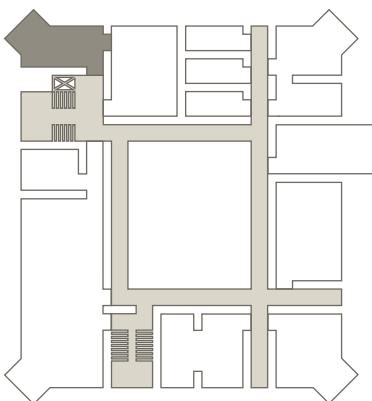

Equipment

- Video/Audio**
- weframe One 86" (219 cm diagonal, multitouch 4K display) with HDMI port
 - Barco ClickShare

- Internet**
- WLAN/LAN

- Facilitation**
- 1 large presentation kit
 - 1 quality flipchart with wheels
 - 2 quality pinboards with wheels

- And...**
- Dial extension -934 for immediate support



As well as notepad and pen at the desk for each participant



The room Barockzimmer is located on the second floor of the castle and is 31 sqm big. It features an oriel, about 2.5 m x 2.5 m big. The arrangement of the seating is flexible.

Category	Floor space	Ceiling high	Length/Width
S	31 sqm	2.8 m	6.2 m x 5.0 m

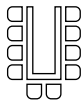
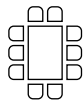
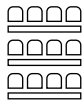
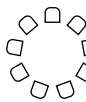
Capacity

				
U-shape	Boardroom style	Classroom style	Round table	Theatre style
8	8	8	10	15

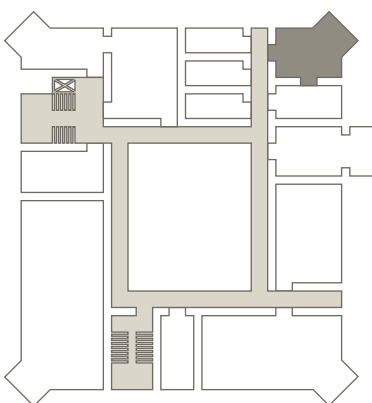

Equipment

Internet

- WLAN/LAN

Facilitation

- 1 presentation kit
- 1 quality flipchart
- 1 quality pinboard

And...

- Dial extension -934 for immediate support

As well as notepad and pen at the desk for each participant



The room Klausur 4 is located on the first floor of the castle and is 30 sqm big. It features an oriel, about 2.5 m x 2.5 m big. The arrangement of the seating is flexible.

Category	Floor space	Ceiling high	Length/Width
S	30 sqm	3.2m	6.1 m x 4.8 m

Capacity

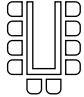
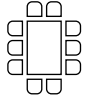
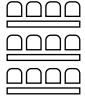
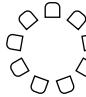
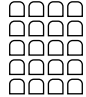
				
U-shape	Boardroom style	Classroom style	Round table	Theatre style
8	8	8	10	15

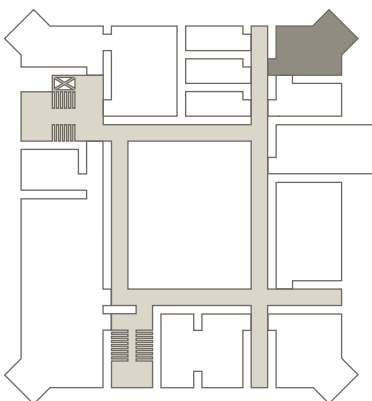

Equipment

Internet

- WLAN/LAN

Facilitation

- 1 presentation kit
- 1 quality flipchart
- 1 quality pinboard

And...

- Dial extension -934 for immediate support



As well as notepad and pen at the desk for each participant



The room Klausur 6 is located on the second floor of the castle and is 27 sqm big. The arrangement of the seating is flexible.

Category	Floor space	Ceiling high	Length/Width
S	27 sqm	2.8 m	6.7 m x 4.1 m

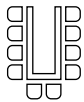
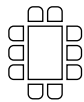
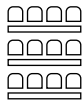
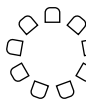
Capacity

				
U-shape	Boardroom style	Classroom style	Round table	Theatre style
6	6	6	6	10

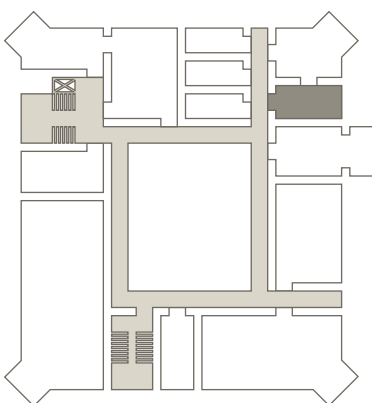

Equipment

Internet

- WLAN/LAN

Facilitation

- 1 presentation kit
- 1 quality flipchart
- 1 quality pinboard

And...

- Dial extension -934 for immediate support

As well as notepad and pen at the desk for each participant

Breakout Room 1



2021 08 06



The Breakout Room 1 is located on the second floor of the Gutshof and is 26 sqm big. The arrangement of the seating is flexible.

Category	Floor space	Ceiling high	Length/Width
S	26 sqm	2.4 m	8.2 m x 3.2 m

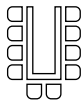
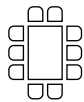
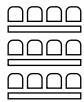
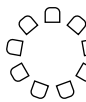
Capacity

U-shape	Boardroom style	Classroom style	Round table	Theatre style
				
-	8	-	8	-

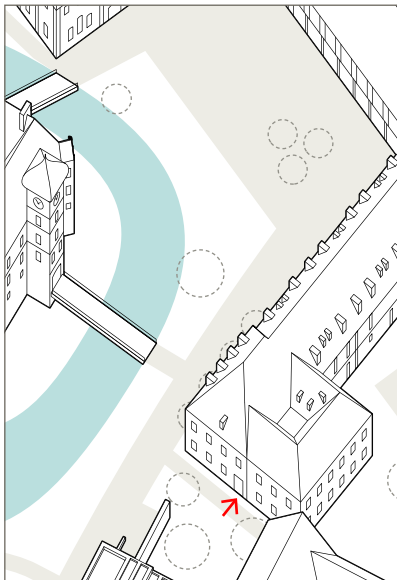

Equipment

Internet

- WLAN/LAN

Facilitation

- 1 presentation kit
- 1 quality flipchart
- 1 quality pinboard

And...

- Dial extension -934 for immediate support



As well as notepad and pen at the desk for each participant



The room Klausur 5 is located on the first floor of the castle and is 24 sqm big. The arrangement of the seating is flexible.

Category	Floor space	Ceiling high	Length/Width
S	24 sqm	3.2m	6.2 m x 3.8 m

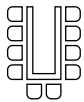
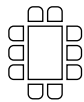
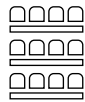
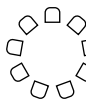
Capacity

				
U-shape	Boardroom style	Classroom style	Round table	Theatre style
6	6	6	6	10

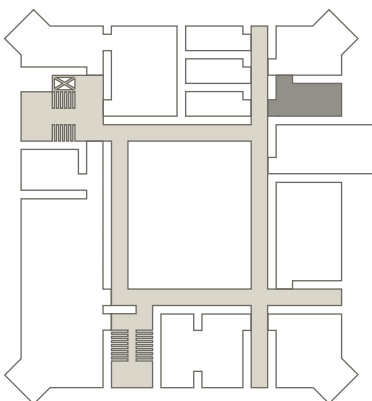

Equipment

Internet

- WLAN/LAN

Facilitation

- 1 presentation kit
- 1 quality flipchart
- 1 quality pinboard

And...

- Dial extension -934 for immediate support

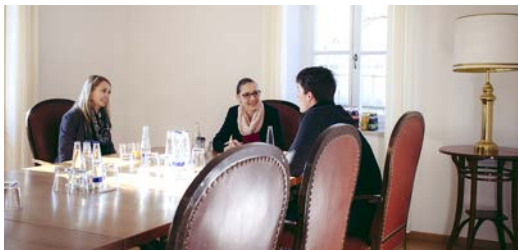

As well as notepad and pen at the desk for each participant



The room Durchblick is located on the ground floor of the Altes Försterhaus and is 23 sqm big. The seating arrangement is permanent.

Category	Floor space	Ceiling high	Length/Width
S	23 sqm	2.9m	6.1 m x 3.8 m

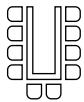
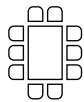
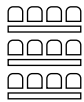
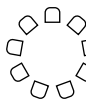
Capacity

				
U-shape	Boardroom style	Classroom style	Round table	Theatre style
-	8	-	-	-

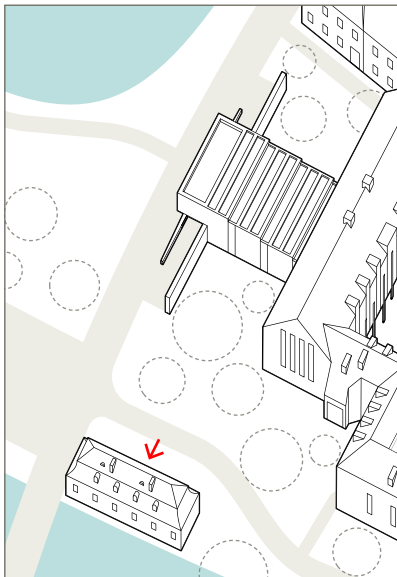

Equipment

- Internet**
 - WLAN
- Facilitation**
 - 1 presentation kit
 - 1 quality flipchart
 - 1 quality pinboard

And...

- Dial extension -934 for immediate support
- As well as notepad and pen at the desk for each participant

Breakout Room 2



2021 08 06



The Breakout Room 2 is located on the second floor of the Gutshof and is 22 sqm big. The arrangement of the seating is flexible.

Category	Floor space	Ceiling high	Length/Width
S	22 sqm	2.4 m	5.7 m x 3.8 m

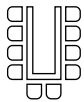
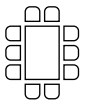
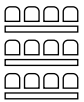
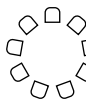
Capacity

				
U-shape	Boardroom style	Classroom style	Round table	Theatre style
-	8	-	8	-

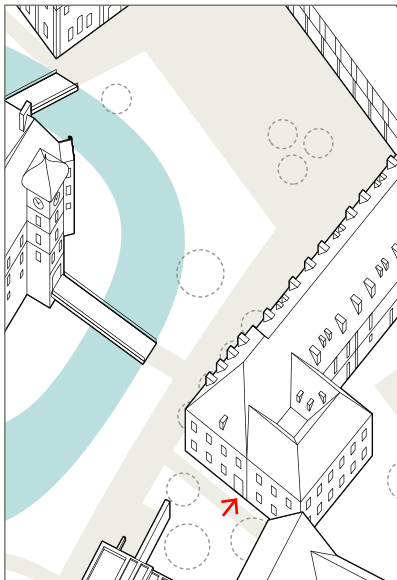

Equipment

Internet

- WLAN/LAN

Facilitation

- 1 presentation kit
- 1 quality flipchart
- 1 quality pinboard

And...

- Dial extension -934 for immediate support

As well as notepad and pen at the desk for each participant

Breakout Room 3



2021 08 06



The Breakout Room 3 is located on the second floor of the Gutshof and is 18 sqm big. The arrangement of the seating is flexible.

Category	Floor space	Ceiling height	Length/Width
S	18 sqm	2.4 m	4.8 m x 3.8 m

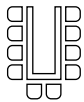
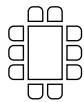
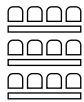
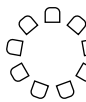
Capacity

U-shape	Boardroom style	Classroom style	Round table	Theatre style
				
-	8	-	8	-

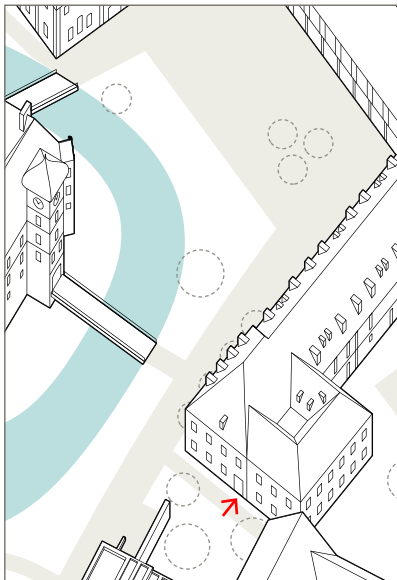

Equipment

Internet

- WLAN/LAN

Facilitation

- 1 presentation kit
- 1 quality flipchart
- 1 quality pinboard

And...

- Dial extension -934 for immediate support

As well as notepad and pen at the desk for each participant